



Perley Health

Community of Care

Overview

Perley Health is a community where Seniors and Veterans thrive – from independent living to long-term care. We support each resident along a person- and family-centric continuum of care to improve not only their physical well-being, but their mental and emotional health, too. We affirm our values of compassion, respect, integrity and excellence.

First Floor

- 1A Main Entrance
- 1B Reception Desk/Security
- 1C Volunteer Services
- 1D Adult Day Program
- 1E Dental Clinic
- 1F The Care Clinic at Perley Health
- 1G Pharmacy
- 1H Perley Health Foundation
- 1I Deborah's Gift Boutique
- 1J Food & Nutrition Meeting Room
- 1K Jo's and Denny's Pub
- 1L Cafeteria
- 1M Lupton Hall
- 1N Chapel
- 1O Spiritual Health Offices

Second Floor

- 2A Administration Offices
- 2B Finance Office
- 2C Conference Room #3
- 2D John and Jennifer Ruddy MET Gallery
- 2E Benidickson Boardroom #1
- 2F Classroom #2
- 2G Staffing Office
- 2H Staff Training Centre
- 2I Administration Annex
- 2J Studio: Paint and Woodworking
- 2K Studio: Ceramics
- 2L Perley Health Centre of Excellence in Frailty-Informed Care™
- 2M BMO Innovation Hub
- 2N Hair Salon
- 2O Louis Audette Games Room
- 2P Sacred Space
- 2Q Occupational Therapy
- 2R Laundry
- 2S Support Services & Admissions

Ottawa Freemasons' Living Classroom:
 Algonquin Living Classroom - Ottawa 2 East
 The Specialized Behavioural Support Unit (SBSU) - Gatineau Residence, First Floor

Legend

- Elevator
- Stairs
- Restrooms
- Parking Kiosk
- Change Machine

Perley Centre

First Floor

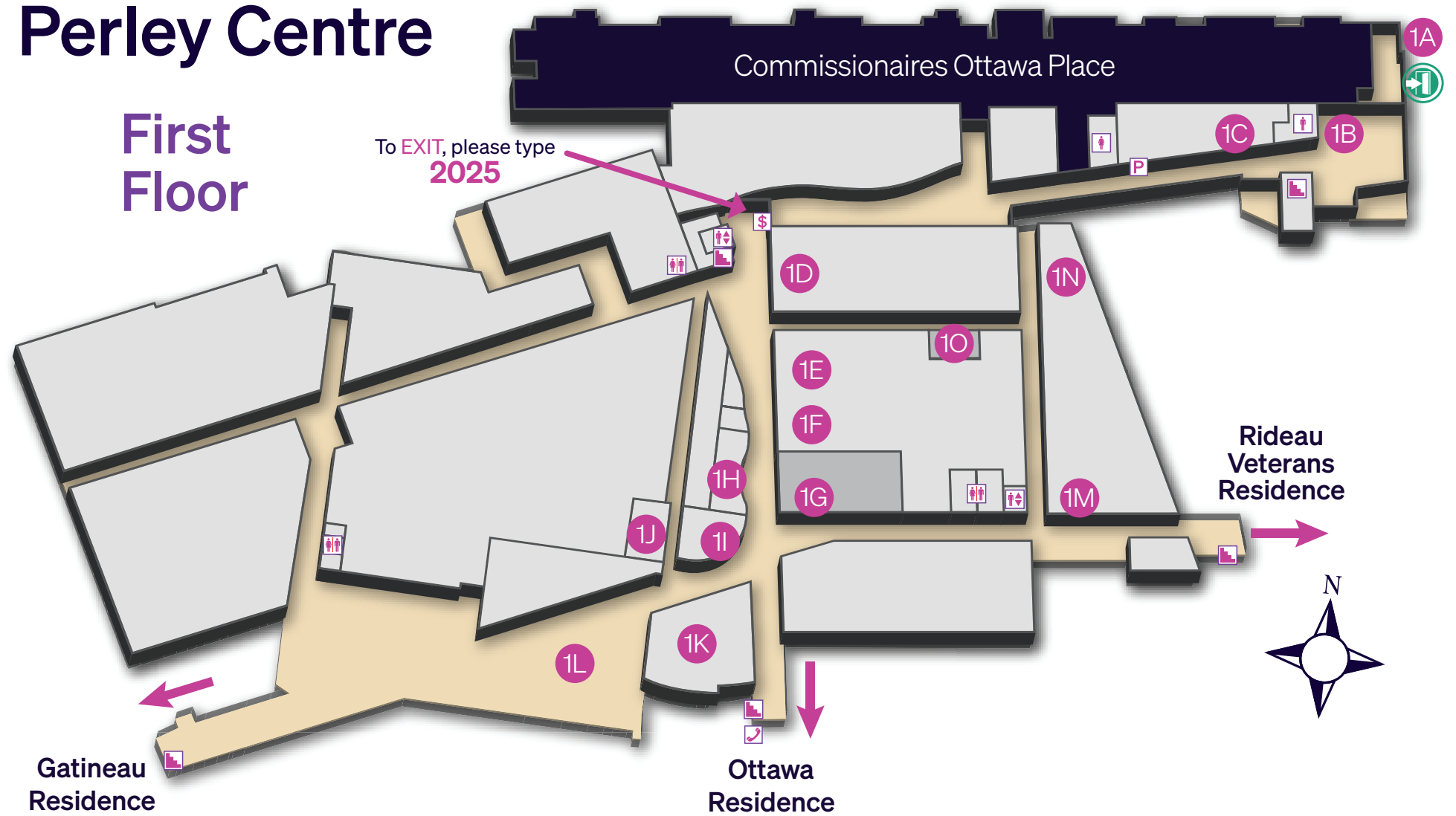

Second Floor

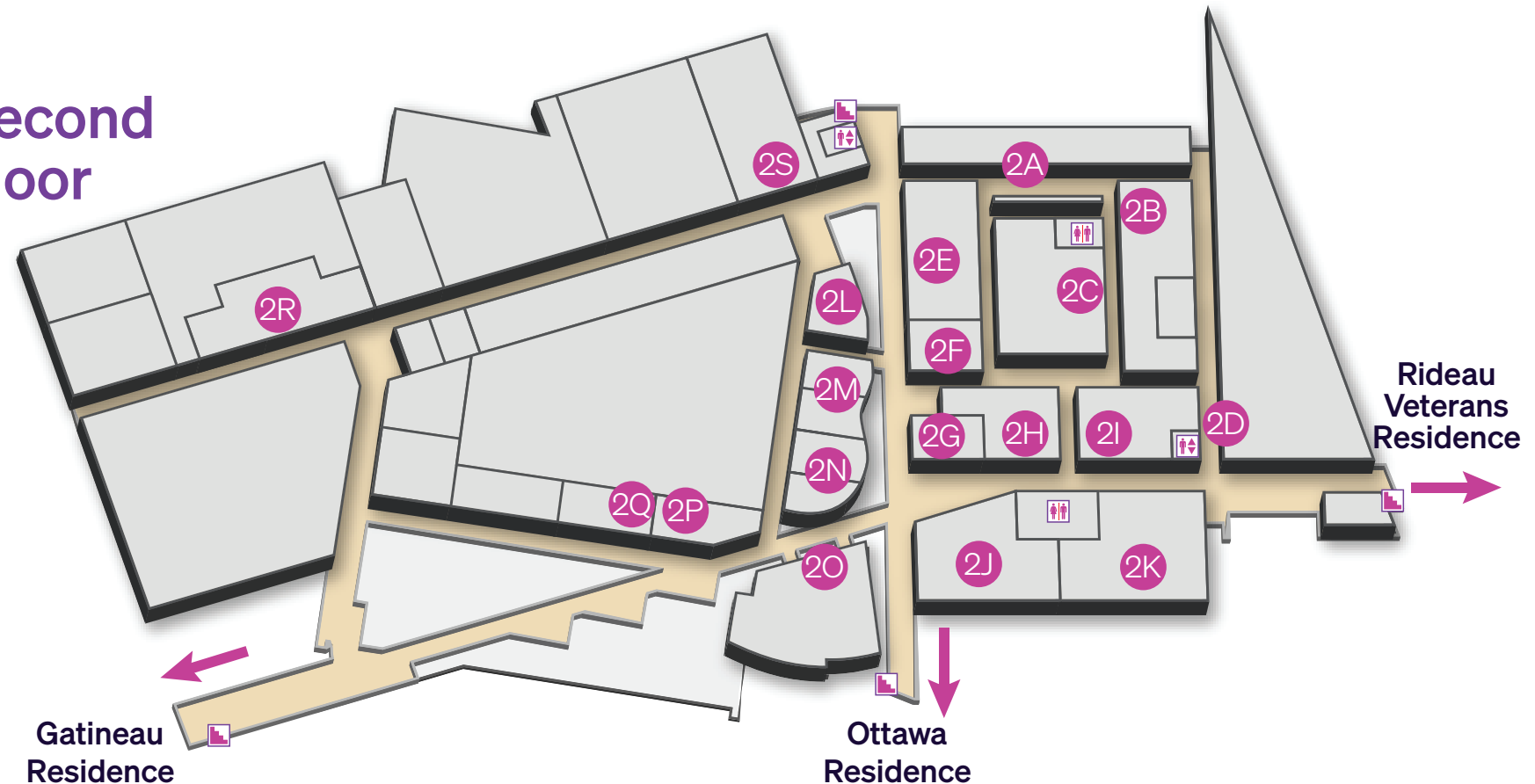

Entrance & Parking Site Plan

Map Overview

Perley Health is a unique and innovative campus of care. Home to more than 600 Seniors and Veterans living in independent apartments or receiving long-term care, Perley Health is also a centre for research, education, and clinical and therapeutic services. From the person-centred and frailty-informed care we provide within our walls to the imperative research we conduct to inform the greater community – everything we do ensures Seniors and Veterans can enjoy their best quality of life, at any stage of the aging process.

Parking

Visitor parking is available in front of the Main Entrance, the Rideau Residence and the Gatineau Residence.

There is a daily rate that is payable at the gate by Interac or credit card when exiting.

Take a paper ticket when arriving at the gate and pay at the gate or pay at the parking kiosk just inside our Main Entrance (Visa, MasterCard or Interac card accepted at both locations). For more information visit

www.PerleyHealth.ca/parking

Up To Date News

Access information for visitors providing urgent news, outbreak updates and safety protocols, please visit our dedicated web page:

www.PerleyHealth.ca/public-announcement

*** Main Entrance:** Also to be used by volunteers, students, and employees of other service providers.

****If there are no available Visitor parking spots, visitors are welcome to park in any available spot **except those reserved for Senior Living apartment tenants.****

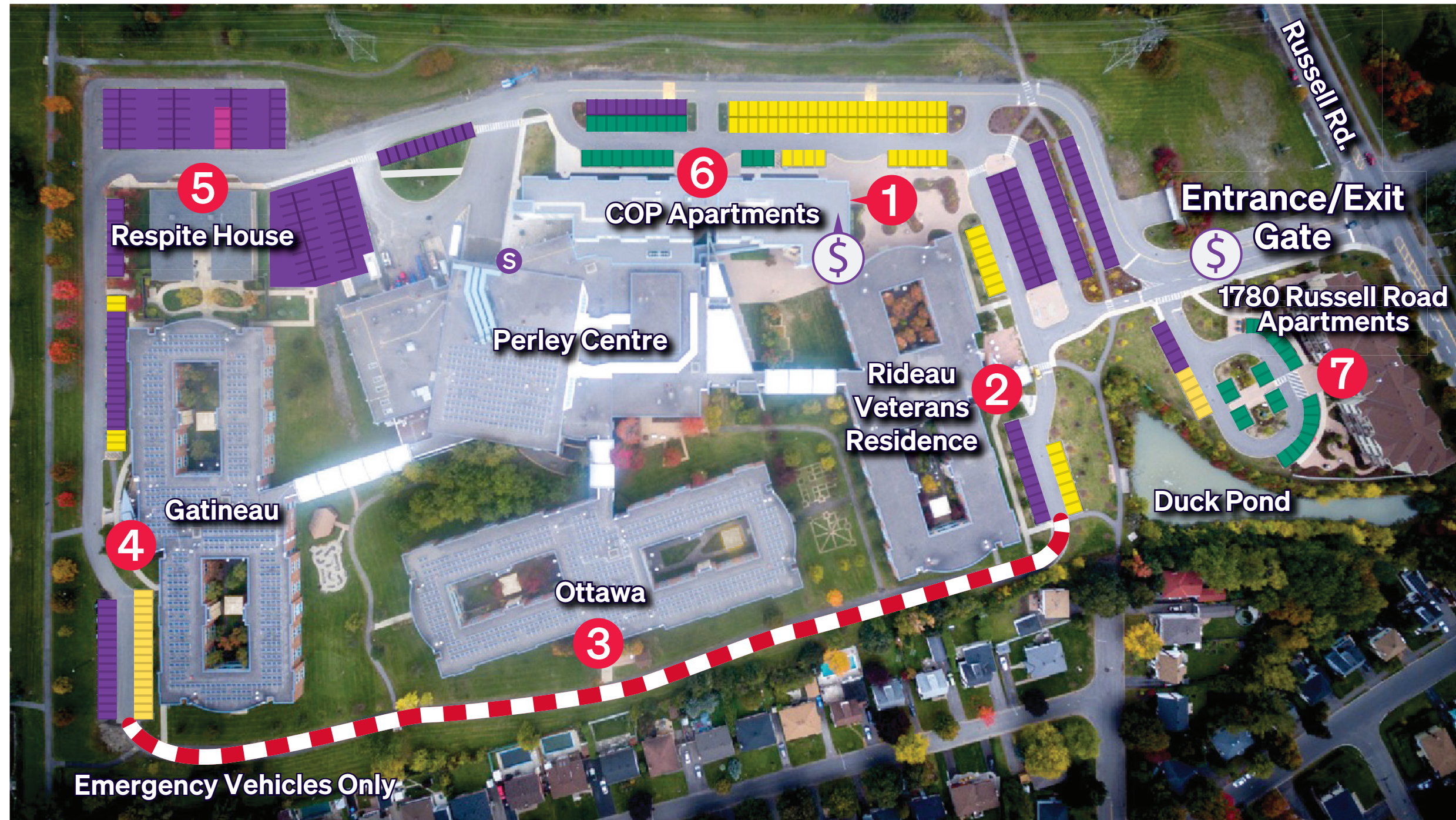

Entrances

- 1** Main Entrance (Perley Centre) Perley Health*
1750 Russell Road
- 2** Rideau Veterans Residence
- 3** Ottawa Residence
- 4** Gatineau Residence
- 5** Respite House at Perley Health
- 6** Commissionaires Ottawa Place (COP)
1720 Russell Road
- 7** Apartments
1780 Russell Road
- S** Staff Entrance

Parking

- Apartment Tenants
- Staff, Students & Volunteers
- Visitors**
- Visitors to Respite House at Perley Health
- Emergency Vehicles Only
- \$ Parking Kiosk/Payment

